

## M1C

Compact Passthrough Dishwasher with Heat Recovery Unit – 450mm rack  
**W 630mm x D 660mm x H 2030mm**

The Washtech M1C is a compact, versatile and highly efficient passthrough dishwasher that combines the latest technology with heavy duty stainless steel construction and componentry. With economical water consumption rates, integrated heat recovery system and powerful rinse heating, the M1C provides excellent wash results while being light on operating costs and the environment.

The M1C's intuitive electronic controls provide Soft Start, EcoPower, cycle customisation, chemical adjustability and immediate fault diagnosis. The M1C is fitted with a highly efficient heat recovery unit that minimises energy consumption and steam emissions for even lower operating costs and an improved working environment. Capable of fitting into a 510mm bench gap with 600mm deep benching, the M1C is the perfect machine for busy rest homes and restaurant kitchens with limited space.

Since 1981 Washtech dishwashers have been constructed from heavy-duty stainless steel, and are engineered specifically for Australian conditions and regulations. Backed by the most extensive service network and spare parts inventory in the region, your Washtech M1C will not let you down.

### Special Features

- Suitable for installation without an extraction canopy in many situations
- Integrated heat recovery unit reduces steam emissions and energy consumption and optimises cold water operation
- Compact passthrough suitable for a 510mm benchgap and 600mm deep benching

### Standard Features

- Autostart on hood closure
- 1, 2 and 3 minute cycles
- Capacity of up to 840 plates / 960 glasses per hour
- Compatible with 365mm to 450mm racks
- Low water consumption of 2.4 litres per cycle
- Heavy-duty stainless steel construction and wash manifold
- Reliable double filtration system via scrap trays and separate wash inlet filter
- Advanced electronic controls
- Soft start wash cycle
- Easy installation with:
  - Water supply hose
  - Detergent and rinse aid pumps with injector lines
  - Drain pump with outlet hose
- Self-cleaning cycle
- EcoPower - reduced temperatures and energy consumption when machine is idle
- Watermark approved backflow prevention
- Moffat's comprehensive 5-2-1 Warranty

### Includes:

- 2 x 450mm dish rack (600 70081)
- 1 x 450mm cup rack (600 70080)
- 1 x cutlery container (C660503)



## M1C



moffat.com.au  
washtech.com.au

### Moffat Pty Limited

#### VIC/TAS/SA

70 Springvale Road  
Mulgrave, Victoria 3170  
Telephone 03-9518 3888  
Fax 03-9518 3833  
vsales@moffat.com.au

#### NSW

Telephone 02-8833 4111  
nswsales@moffat.com.au

#### QLD

Telephone 07-3630 8600  
qldsales@moffat.com.au

#### WA

Telephone 08-9413 2400  
wasales@moffat.com.au

In line with policy to continually develop and improve its products, Washtech reserves the right to change specifications and design without notice.

© Copyright Moffat Ltd  
Version: WM10031 2101

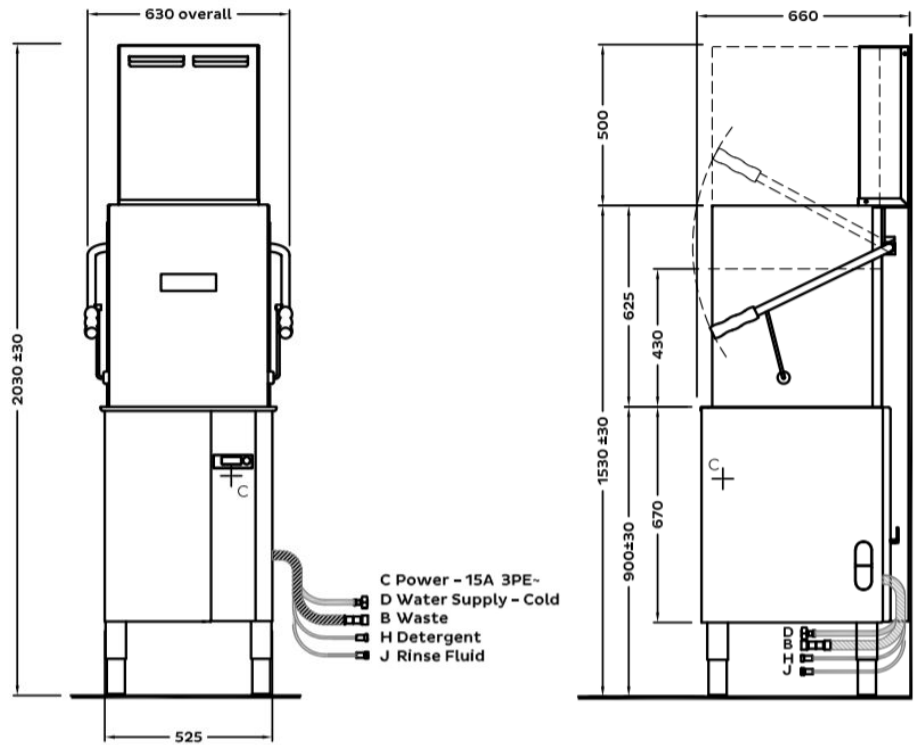

#### Bench detail

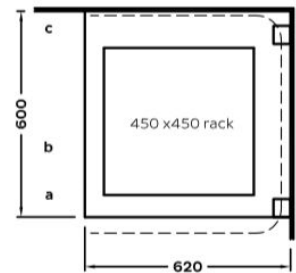
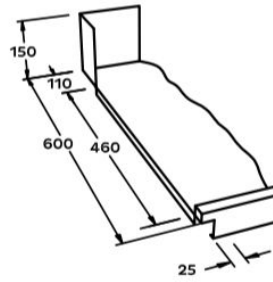
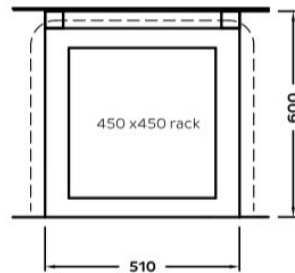

#### D - Cold Water

Temperature <25°C  
Connection 3/4" male; hose supplied  
Pressure 100-350kPa  
Flow 10 litres per min  
Quality Potable - refer table  
Backflow Prevention AVB  
Consumption 2.4 litres per cycle

#### B - Waste - Pumped Drain

Connection Hose supplied for open standpipe  
750 high or connection to sink trap

C - Electrical	V	Hz	A/phase	Max kW
Three Phase	415	50	15	8.61
Single Phase	240	50	25	5.37

#### Dimensions

	Machine	Packed
Width (mm)	630	695
Depth (mm)	660	750
Height (mm)	2030	1970
Weight (kg)	80	101
Volume (m <sup>3</sup> )		1.03

#### Water Quality

	Min	Max
pH	7	8
Hardness (ppm)	20	100
Cl <sup>-</sup>		100
SO <sub>4</sub>		400
Fe		0.1
Mn		0.5
Cu		0.05
Cl <sub>2</sub>		0.1

#### Corner Installation Notes

- Machine must face left for easy access to controls
- Allow 300 clearance to front for service access
- Splashback return must be no higher than 150

Isolating switch must be within 1m of, and not directly behind the machine.

Suitable for installation without extraction canopy in most instances. Full certification from SEED available on request.

Refer to operator manual for installation instructions.



an Ali Group Company



The Spirit of Excellence

