

GE

Economy Compact Glasswasher W 440mm x D 515mm x H 780mm

Washtech's GE is a compact glasswasher ideal for the tightest of locations. The XG features Washtech Hybrid Controls which combine IP65 stainless switches, tried-and-tested switchgear, with a customisable electronic timer.

Since 1981 Washtech dishwashers and glasswashers have been constructed from heavy-duty stainless steel, and are engineered specifically for Australian conditions and regulations. Backed by the most extensive service network and spare parts inventory in the region, your Washtech glasswasher will not let you down.

Standard Features

- Rapid 1 minute glasswashing wash cycle
- Washes up to 540 glasses per hour
- Hot water consumption of 4.5 litres per cycle
- Washtech Hybrid Controls
- Self-cleaning cycle
- Selectable cold rinse
- Easy installation, supplied complete with:
 - Dual water supply hoses (hot & cold)
 - Detergent injector with injector line
 - 15 amp plugset
 - No commissioning required
- Heavy-duty stainless steel construction
- Lower wash/rinse arm with precision moulded jets and an upper rinse jet
- Watermark approved backflow prevention
- Comprehensive 5-2-1 Warranty

Includes:

- 1 x 365mm glass rack (K0401)

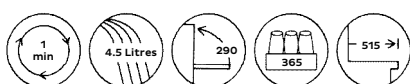

GE

Economy Compact Glasswasher W 440mm x D 515mm x H 780mm

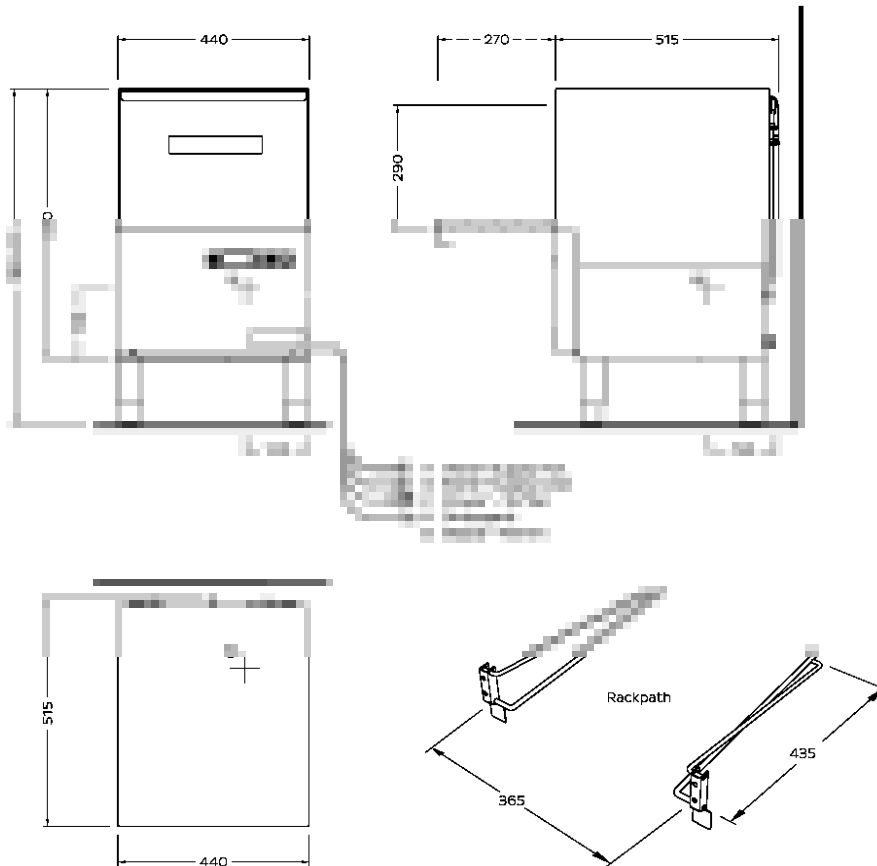

moffat.com.au

Australia
Moffat Pty Limited

Victoria/Tasmania
740 Springvale Road
Mulgrave, Victoria 3170
Telephone 03-9518 3888
Facsimile 03-9158 3833
vsales@moffat.com.au

New South Wales
Telephone 02-8833 4111
nswsales@moffat.com.au

South Australia
Telephone 03-9518 3888
vsales@moffat.com.au

Queensland
Telephone 07-3630 8600
qldsals@moffat.com.au

Western Australia
Telephone 08-9202 6820
wasales@moffat.com.au



ISO9001
All Washtech products are designed and manufactured by Washtech using the internationally recognised ISO9001 quality management system, covering design, manufacture and final inspection, ensuring consistent high quality at all times.

In line with policy to continually develop and improve its products, Washtech reserves the right to change specifications and design without notice.



© Copyright Moffat Ltd
Version: 1903

| | | | | | |
|---|---------------------|----------------------------|----------------|---------------|--|
| A Hot water | Temperature | 65°C | | | |
| | Connection | 3/4" male; hose supplied | | | |
| | Pressure | 200-350kPa | | | |
| | Flow | 20 litres per min | | | |
| | Quality | Potable - refer table | | | |
| | Backflow Prevention | Atmospheric Vacuum Breaker | | | |
| | Consumption | 4.5 litres per cycle* | | | |
| D Cold water (optional cold rinse) | Temperature | 20°C | | | |
| | Connection | 3/4" male; hose supplied | | | |
| | Pressure | 200-350kPa | | | |
| | Flow | 20 litres per min | | | |
| | Quality | Potable - refer table | | | |
| | Backflow Prevention | Atmospheric Vacuum Breaker | | | |
| B Waste | Connection | 1.5" BSP | | | |
| | Line | 2" BSP | | | |
| C Electrical | V | Hz | A/phase | max kW | |
| Single Phase | 240 | 50 | 15 | 3 | |

| | | |
|-------------------|----------------|---------------|
| Dimensions | Machine | Packed |
| Width | 440 | 480 |
| Depth | 515 | 570 |
| Height | 780 | 740 |
| Weight | 26 | 39 |
| Cubicmetres | | 0.2 |

| | | |
|----------------------|------------|------------|
| Water Quality | Min | Max |
| pH | 7 | 8 |
| Hardness ppm | 20 | 100 |
| CL- | | 100 |
| SO ₄ | | 400 |
| Fe | | 0.1 |
| Mn | | 0.5 |
| Cu | | 0.05 |
| Cl ₂ | | 0.1 |

Refer operator manual for installation instructions. Isolating switch must be within 1m of, and not directly behind the machine.

*Consumption may vary with site conditions.

an Ali Group Company



The Spirit of Excellence